

Work Your Way

Banner Boswell Medical Center (BBWMC): Building information and campus map

Welcome to your workspace at BBWMC. This document will guide you on all the needed information for this flexible workspace.

Building contacts

Facilities Services 623-832-4916	EVS Housekeeping 623-832-5448	Security Services 602-747-4400
----------------------------------	-------------------------------	--------------------------------

Hours

Building hours are 6:30 a.m. to 8:00 p.m., Monday through Friday. After hours entry requires the use of a Banner employee badge

[Badge and Security Service Ticket Request](#)

Workspace reservation

Remember to cancel reservations - If you booked space you no longer need, be sure to go back into the Outlook system and cancel your reservation so that it is available for your colleagues.

Etiquette

Leave the workspace the way you'd like to find it - Don't forget to take your papers, chargers, and personal belongings.

You're probably louder than you think you are - Refrain from using speaker phones in workstations and open areas.

Parking

All parking is first-come, first-served. Please do not park in handicap spaces unless you have a handicap permit. Employees may not park in the "Visitor Parking" at any time. All red fire lanes and "No Parking" areas must always be observed.

Repairs, Maintenance & Housekeeping

For any repairs, maintenance, clogged drains, A/C, kitchen supplies or housekeeping issues, please submit a TMA Repair Request.

When leaving, please set the trash can outside the workspace. If the desk needs additional or special cleaning, please submit a TMA request center ticket for this location.

[TMA iService Desk](#)

Equipment

The equipment in this cube including the chair, phone, surge protector, cords, keyboard and mouse is not to be removed or moved to another location. Should the equipment need repair, please submit a service Hub ticket.

[Banner Service Hub](#)

Campus map & Floor plan

10401 W Thunderbird Blvd
Sun City, AZ 85351





Banner Boswell Medical Center



Banner Boswell
Medical Center



Driving Directions

To reach Banner Boswell Medical Center from the 101 Freeway
Exit Thunderbird Road heading west. Turn left at 105th Ave.
Banner Boswell Medical Center is on the southeast corner
of the street.

Campus Transportation

Courtesy cart service to and from your vehicle is available in most
parking areas. Please visit our Volunteer Services desk located at
the main public entrances for assistance.

Visitor's Guide and Map

10401 W. Thunderbird Blvd. • Sun City, AZ 85351
(623) 832-4000 • www.BannerHealth.com/Boswell
www.facebook.com/BannerBoswell

BANNER BOSWELL MEDICAL CENTER (BBWMC)

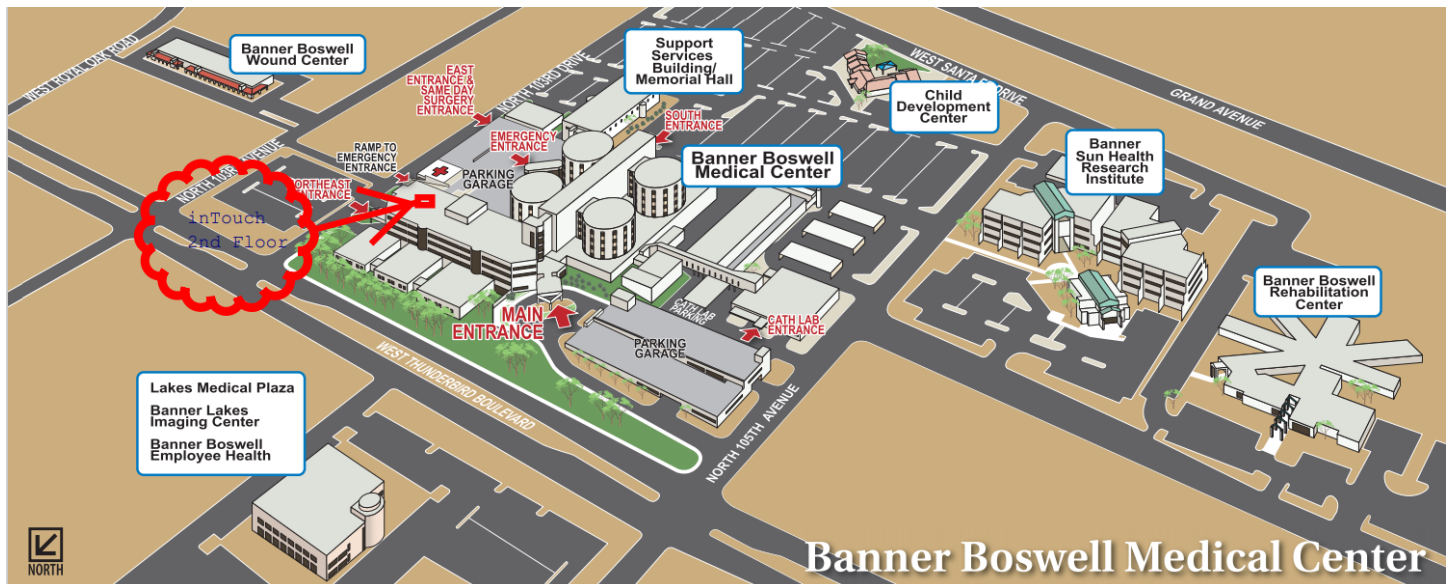
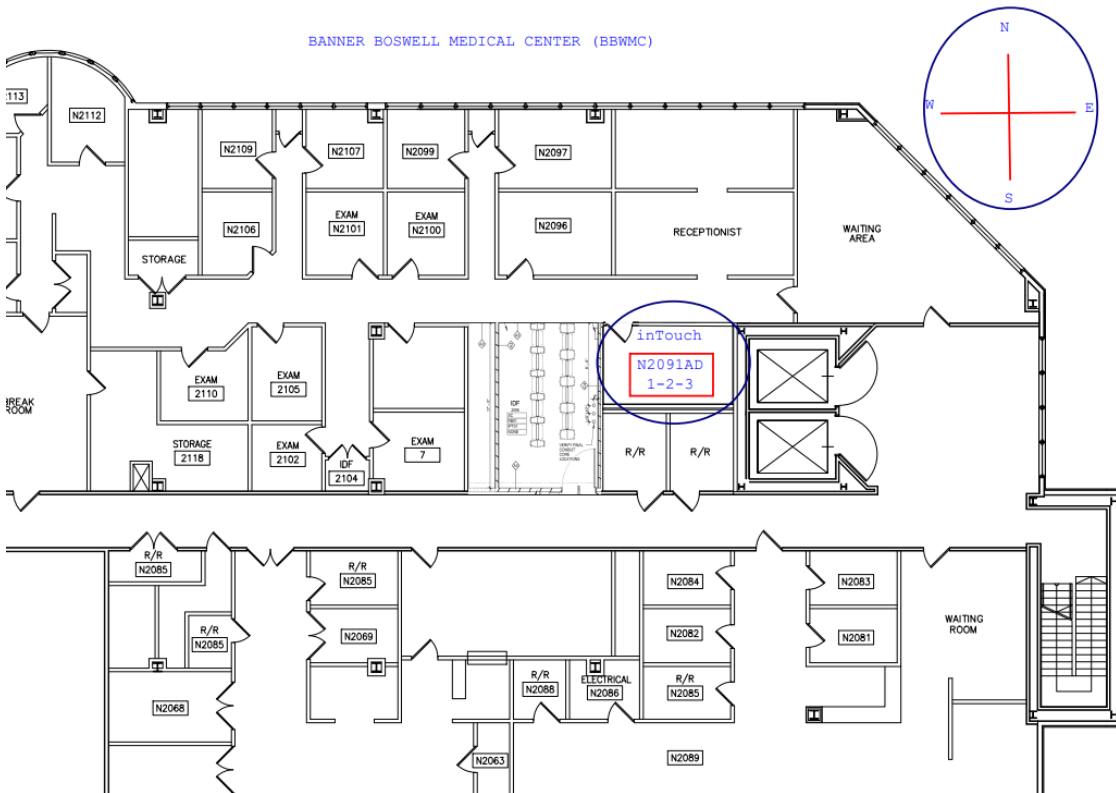

Visiting Hours

We recognize the importance of family and friends in the healing process and encourage their presence during your stay. Visiting hours are dependent on patient condition. Please be considerate as we do our best to meet your needs.

Remember, our patients always must be our first priority. Thank you for assisting us with these guidelines:

- Our visiting hours are 24 hours per day.
- Routinely two visitors per patient.
- We encourage all visitors to wash their hands when they first enter the room and after any contact. Hand sanitizer is conveniently located throughout our facility, please feel free to use routinely.
- Visitation by children under age 12 is on a case-by-case basis. Please contact staff to make arrangements.

- To protect our patients, please refrain from visiting if you are ill, have a cough or fever.
- Visitation of patients in isolation depends on the patient's condition. Please be aware of precautions, you may be required to wear a gown, mask, and gloves. If you are not sure or unable to follow these precautions, staff will assist you.
- Fresh flowers are not allowed in some patient-care areas. Please check with nursing staff before bringing flowers to patient rooms.
- Latex balloons are not permitted because of possible latex allergies, but mylar balloons may be brought to patients.
- Please avoid touching or adjusting any of the patient-care equipment, including vacant beds.
- Overnight accommodations may not be available.

ATM

An ATM machine is located in the cafeteria vending area. There are no banking services available on the hospital campus; however, local banks are conveniently located nearby.

Cafeteria

Monday through Friday:
Breakfast from 6 a.m. to 9:45 a.m.
Lunch from 11 a.m. to 2:30 p.m.
Dinner from 4 p.m. to 7 p.m.
Grill from 4 p.m. to midnight

Weekends and holidays:
Breakfast from 7 a.m. to 9:45 a.m.
Lunch from 11 a.m. to 2:30 p.m.
Grill from 4 p.m. to 7 p.m.

Lobby Latte Gourmet Coffee Bar

Lobby Latte offers gourmet coffee and other refreshments and is located inside the main entrance of Banner Boswell Medical Center. Lobby Latte is open Monday through Friday from 7 a.m. to 4 p.m.

Vending Machines

Vending machines are located on the group floor in the Cafeteria and near surgery family waiting, on the first floor near the main lobby and the Emergency department waiting area; on the second floor in the south waiting area; on the third floor in the north and south waiting areas; and on the fourth and fifth floors in the south waiting areas.

Gift Shop

Weekdays - 9 a.m. to 5 p.m.
Saturday - 10 a.m. to 2 p.m.
Sunday - noon to 4 p.m.

Our gift shop is located near our main entrance. We offer visitors a collection of books, magazines, flowers, greeting cards, stamps, games, puzzles and keepsakes.

Banner Boswell Medical Center is a tobacco-free campus.

